

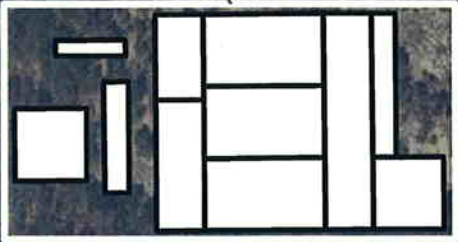

Sequencing Batch Reactor (SBR) WWTF

Kitredge Road



SANDWICH
FALMOUTH

Data Source: MassGIS/Town of Falmouth
GIS Department

1 inch = 200 feet

Location: N:\US\Hyannis\S&W\GIS\Jobs\70000171045
Falmouth\Figures\12_9_2009 Report Figures\
PDF\71045F4-4.mxd



STEARNS & WHEELER^{LLC}
Environmental Engineers & Scientists

HYANNIS, MASSACHUSETTS

1546 Hyamough Road
Phone: 508-367-5983
Fax: 508-362-5994
Web: stearnswheeler.com

Job No.: 71045

Date: 5/06/2008

Town of Falmouth, Massachusetts
CWMP

New ENR WWTF
At The MMR Site

FIGURE 4-4